

Aussies hit the international stage at Grand Designs Live

By Glenice Buck – Glenice Buck Designs

The Australian Institute of Landscape Designers and Managers (AILDM) partnered with the team from Grand Designs Live to create four show gardens at this year's Grand Designs Live event held recently in Sydney.

The designers were given a 4 metre x 4 metre space to showcase their talents. The criteria for the show gardens were to demonstrate the importance of outdoor design in a small urban area. The designers were expected to display an innovative use of small space design as well as illustrating ways of creating sustainable, practical and beautiful gardens.

The result was that four amazing grand show gardens were constructed, each completely different, yet all were stunning urban sanctuaries.

The AILDM members who were chosen to be involved with the grand show gardens were:

- Steve Warner - Outhouse Design
- Craig MacDonald - Spade Design
- Fiona Ericsson and Julia Thomas - Sticks and Stones Landscape Design
- Glenice Buck - Glenice Buck Designs

From the outset all four companies decided to work together as much as possible - from obtaining sponsorship, nutting out the design process and also sharing roles and responsibilities.

There is no doubt in my mind this was one of the best experiences of my career - sharing, communicating and helping each other out was fantastic.



Steve Warner - 'Urban Nest'

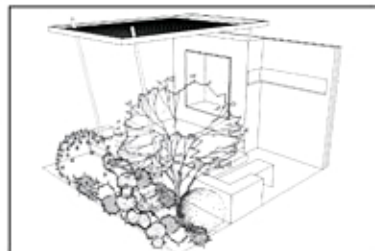

Craig MacDonald - 'Coastal Retreat'



Fiona Ericsson and Julia Thomas - 'The Courtyard'



Glenice Buck - 'Pollination'

Innovative use of small space design



The teams benefitted from working together

With only 12 hours to go before the grand opening, all the designers were finalising their own designs and checking with everyone else to ensure they were on track and happy with their progress. There was no competitive streak or attitude shown to each other, everyone offered genuine thought, care and concern. This, in my mind, is something all involved should be proud of.

There were benefits from working together. We had more bargaining power and greater appeal to companies for sponsorship, more drive with organisers, and also a base from which we could all communicate and share information and knowledge. This to me seems to be the most advantageous way of co-ordinating such a big effort. It worked on all fronts.

We each designed four completely different styles of gardens. Outhouse designed a modern courtyard called the 'Urban Nest', Spade Design designed a seaside courtyard called the 'Coastal Retreat', Sticks and Stones Landscape Design designed a contemporary outdoor entertaining courtyard called 'The Courtyard' and I designed a flowering enclosed space focused on the importance of bees in the urban environment called 'Pollination'.

Over the next four issues of Hort Journal Australia we will showcase each of the four show gardens, explaining why the designers got involved, what the design process was like, why they chose the planting palettes and how they found the experience.



Outhouse Designs - a modern courtyard called the 'Urban Nest'



Detail - 'Urban Nest'